

Cable connectors

Description and purpose

VK1-40 (RK1-40), PKK1 and VK1-50 cable connectors are used in combination with semirigid cables, RK1-18 (VK1-18), RK1-20 (VK1-20), VK1U cable connectors — with flexible cables, and RK1-20-16R (RK1U-20-16R) — with manually shaped cables. Central conductors are made of tempered beryllium bronze and plated with wear-proof gold. The bodies of VK1-40 (RK1-40), RK1-18 (VK1-18), RK1-20 (VK1-20) cable connectors are made of stainless steel. The bodies of RK1-20-16R (RK1U-20-16R), VK1U, PKK1 and VK1-50 cable connectors are made of tempered beryllium bronze and plated with wear-proof gold. Materials and design of the cable connectors provide low loss and reflection levels, high stability of parameters for at least 5000 connect/disconnect cycles for RK1-18 (VK1-18) connectors, 3000 connect/disconnect cycles for PKK1-20 (VK1-20) and VK1U connectors, 2000 connect/disconnect cycles for VK1-40 (RK2-40) connectors, at least 500 connect/disconnect cycles for RK1-20-16R (RK1Y-20-16R), PKK1 connectors and at least 300 connect/disconnect cycles for VK1-50 connectors.

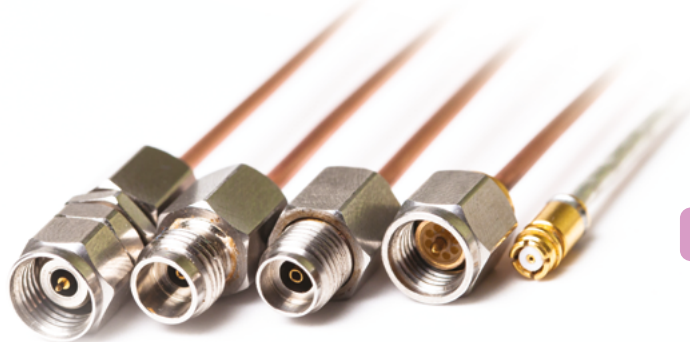

2

Specifications*

Model	Connector	Frequency range, GHz	VSWR, max. (typ.)	Insertion loss for pair, dB, max (typ.)	Operating temperature range, °C	Screen attenuation at 3 GHz, dB, min	Cable type	Fig.
RK1-18-01R-4.72	Type III (female)	0 ... 18	1.1 (1.07)	0.15 (0.08)	-60 ... +90	100	Microcoax UFA210B**	1
RK1-18-11R-4.72	Type N (female)							2
VK1-18-01-4.72	Type III (male)							3
VK1-18-11-4.72	Type N (male)							4
RK1-20-03P-4.72	Type IX, ver. 3 (female)	0 ... 20	1.17	0.25 (0.2)	-60 ... +110	90	EZ_86 (Huber + Suhner) RK50-3-28S, RK50-3-29S	5
RK1-20-13R-4.72	3.5 mm (female)							6
VK1-20-03-4.72	Type IX, ver. 3 (male)							7
VK1-20-13-4.72	3.5 mm (male)							8
VK1U-20-03-4.72	Type IX, ver. 3 (male)							1.15 (1.1)
VK1-20-02-2.2	Type IX, ver. 1 (male)	1.2 (1.15)	0.5 (0.4)	-60 ... +110	70	Sucoform_86 (Huber + Suhner)	6	
VK1-20-12-2.2	Type SMA (male)						7	
PKK1-02-3.6	Type IX, ver. 1 (male)	1.2 (1.15)	0.5 (0.4)	-60 ... +110	70	Sucoform_86 (Huber + Suhner)	8	
PKK1-12-3.6	Type SMA (male)						8	
RK1-20-16P-2.1	Type SMP (female)	1.2 (1.15)	0.5 (0.4)	-60 ... +110	70	Sucoform_86 (Huber + Suhner)	7	
RKU1-20-16R-2.1							8	

* If mounting requirements are met.

** Use of another flexible cable with similar geometric parameters is allowed.

NOTE

For detailed information on use of cable connectors, refer to document General Connectors at www.micran.ru.

Dimensions

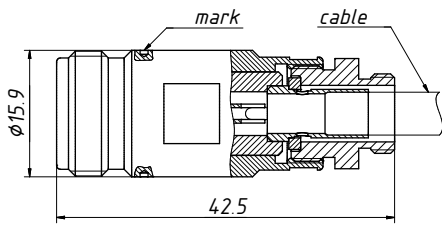

Fig. 1

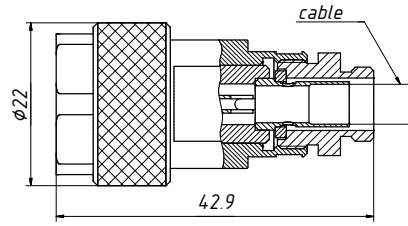

Fig. 2

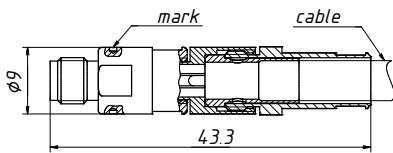

Fig. 3

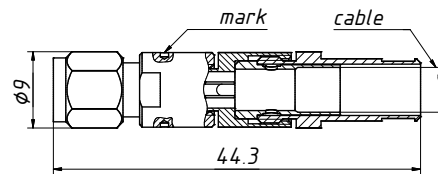

Fig. 4

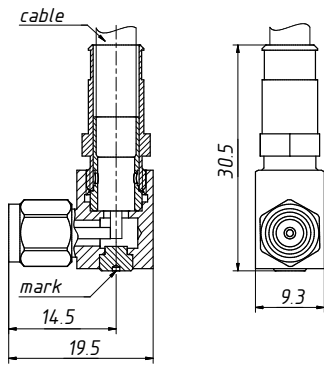

Fig. 5

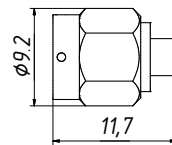

Fig. 6

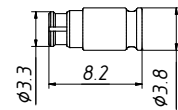

Fig. 7

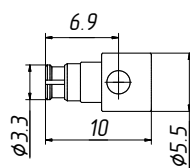

Fig. 8

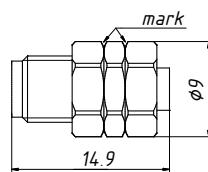

Fig. 9

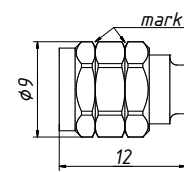

Fig. 10

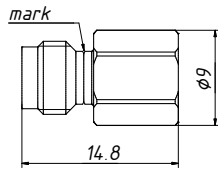

Fig. 11

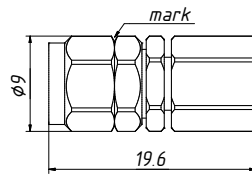

Fig. 12

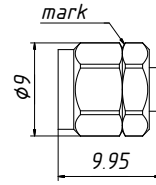

Fig. 13

Ordering example

- RK1-40-14R-2 Cable connector, 2.92 mm (female) for RK50-1.5-22 cable.